



PCSAW 330 band saw machine

Fully automatic with single pulse cutting and SMARTCUT technology



DIMENSIONS

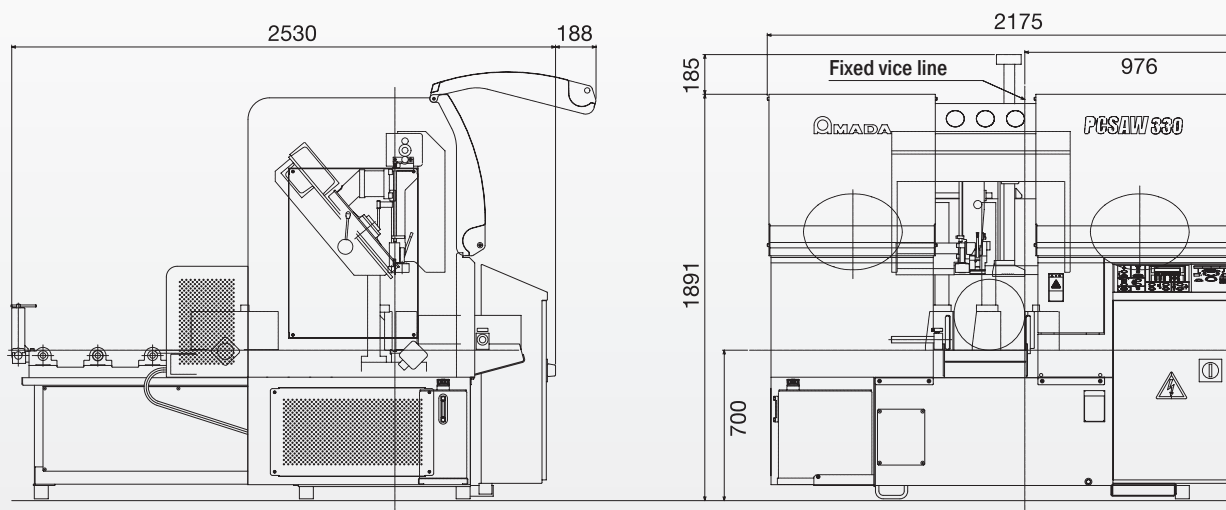

PULSE CUTTING TECHNOLOGY

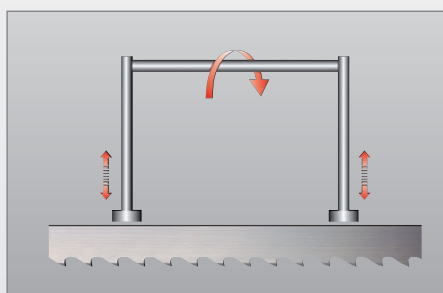

Pulse Cutting technology

The pulsation moves the saw up and down rapidly, generating a wave-like motion that has a positive effect on the cutting behaviour of the sawteeth, therefore reduces the cutting resistance and guides to increased blade lifetime.

PCSAW 330: pulse cutting technology with 41 x 0.9 mm SMARTCUT band saw blade.

The combination of two AMADA developments in the PCSAW 330 full automatic band saw machine sets new standards with respect to performance and efficiency:

- PULSE CUTTING TECHNOLOGY
- SMARTCUT BAND SAW BLADE

In the case of pulse cutting, continuous pulsation in the feed direction optimises specifically the contact situation of the saw band to allow exceptionally high cutting performance. The pre-defined loading and unloading of the sawteeth results in a considerable reduction of the cutting resistance during sawing.

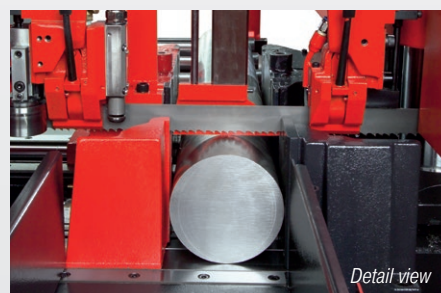

The use of a SMARTCUT 41 mm band saw blade with only 0.9 mm blade thickness specially developed for this machine type, reduces the waste by 25 %, which is particularly advantageous with respect to the efficiency during sawing of expensive materials. This makes the robust, column-guided AMADA PCSAW 330 particularly interesting for large series.

TECHNICAL DATA

Cutting capacity	Ø 330 mm, 330 x 330 mm
Bundle cutting	max. W = 250 mm; min. W = 150 mm max. H = 160 mm; min. H = 25 mm
Motor power	Saw Blade Motor 3.7 kW Hydraulic Pump Motor 1.5 kW Pulse Cutting Motor 0.4 kW
Material feed length	500 mm per stroke
Band speed	15-120 m/min continuously variable
Table height	700 mm

Band saw blade dimension	41 x 0.9 x 4115 mm SMARTCUT band saw blade On request, it is also possible to use conventional size 41 mm band saw blades with a blade thickness of 1.3 mm.
Machine dimensions	W 2175 x H 2076 x D 2530 mm
Machine weight	1800 kg
Colour	red-black
Option(s)	bundle clamping unit (set)

Subject to technical modifications



AMADA MACHINERY EUROPE GmbH

Amada Allee 3, 42781 Haan, Germany

Phone: +49 (0) 2104 1777-0, Mail: info-de@amada-machinery.com, www.amada-machinery.com



740000071